

Department of Environmental Management Sewer Modernization Project

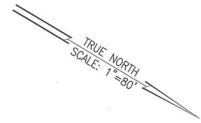

Delete 2 old Sewer Lines on mauka side that were Constructed in 1906 and 1933

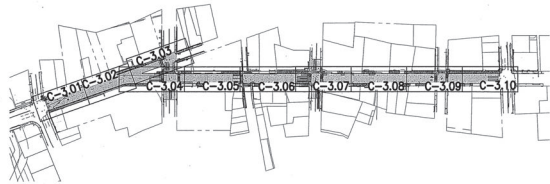
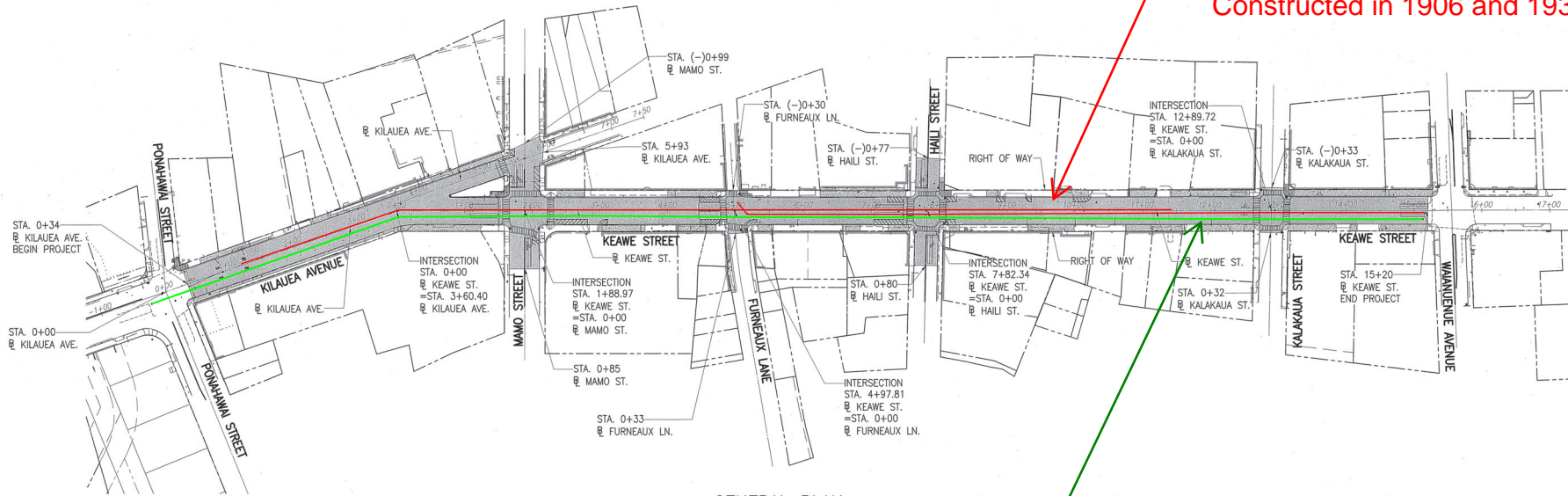

GENERAL PLAN
SCALE: 1"=80'

Reroute sewer laterals on old sewer lines to a newer reinforced concrete sewer main on makai side. This main was constructed in 1963, so it is not new, but it is in serviceable condition

LEGEND:

- ROADWAY WORK
- SIDEWALK WORK
- CURB RAMP WORK



THIS WORK WAS PREPARED BY ME OR UNDER MY SUPERVISION AND CONSTRUCTION OF THIS PROJECT WILL BE UNDER MY OBSERVATION.
ATA DESIGN SYSTEMS & ASSOCIATES, INC.

REVISION	DATE	DESCRIPTION	ENGINEER APPROVED
DEPT. OF PUBLIC WORKS, COUNTY OF HAWAII ENGINEERING DIVISION			
KILAUELA AVENUE AND KEAWE STREET REHABILITATION FROM PONAHAHAI STREET TO WAIANUENUE AVENUE FEDERAL AID PROJECT NO. STP-0100(090) SOUTH HILO, HAWAII			
GENERAL PLAN			
DESIGN	NL	APPROVED:	DRAWING NO.
DRAWN	DO	<i>Robert Thompson</i> DIVISION CHIEF	C-2.01
CHECKED	PA		SHEET NO.
DATE	MAY 2022		11
JOB NO.	E-4633		OF 44 SHEETS
		FILE	DRAW FOLDER
		FILE	POCKET FOLDER NO.